



**BENJAMIN
STEVENS.**
estate agents



79 Rowlands Close, London, NW7 2DN

£1,800 Per Month

Nestled in the charming area of Mill Hill, London, this delightful flat at Rowlands Close offers a perfect blend of comfort and convenience. With two well-proportioned bedrooms, this property is ideal for small families, couples, or individuals seeking a peaceful retreat in a vibrant community.

Upon entering, you are welcomed into a spacious reception room that provides a warm and inviting atmosphere, perfect for relaxation or entertaining guests. The layout is thoughtfully designed, ensuring that every inch of space is utilised effectively. The flat features a well-appointed bathroom, catering to all your daily needs with ease.

The location of this property is particularly appealing, as Mill Hill is known for its picturesque surroundings and excellent transport links. Residents can enjoy the tranquility of suburban life while still being within easy reach of central London. Local amenities, including shops, parks, and schools, are conveniently located nearby, making this flat an excellent choice for those who value accessibility and community.

In summary, this flat at Rowlands Close is a wonderful opportunity for anyone looking to settle in a desirable area of London. With its inviting living spaces and prime location, it promises a comfortable and enjoyable living experience. Do not miss the chance to make this charming property your new home.

Reception Room 17'06 x 13'00 (5.33m x 3.96m)

A spacious and bright reception room

Bedroom 7'08 x 11'11 (2.34m x 3.63m)

Single Bedroom with double glazed window and built in wardrobe.

Bedroom 14'00 x 9'05 (4.27m x 2.87m)

Double bedroom with double glazed window and double wardrobe

Kitchen 7'10 x 9'09 (2.39m x 2.97m)

Fully Fitted Kitchen with gas cooker

Bathroom 7'10 x 6'04 (2.39m x 1.93m)

Family size bathroom

Floor Plan

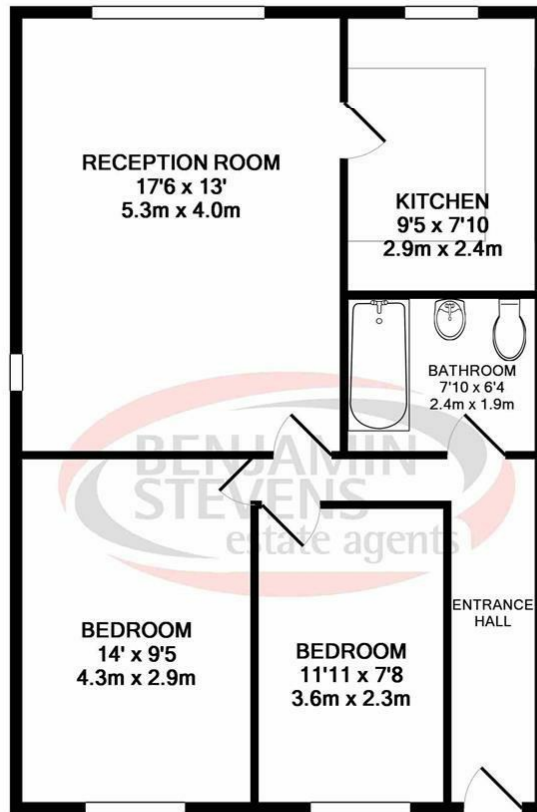

TOTAL APPROX. FLOOR AREA 659 SQ.FT. (61.2 SQ.M.)

Whilst every attempt has been made to ensure the accuracy of the floor plan contained here, measurements of doors, windows, rooms and any other items are approximate and no responsibility is taken for any error, omission, or mis-statement. This plan is for illustrative purposes only and should be used as such by any prospective purchaser. The services, systems and appliances shown have not been tested and no guarantee as to their operability or efficiency can be given
Made with Metropix ©2019

Area Map

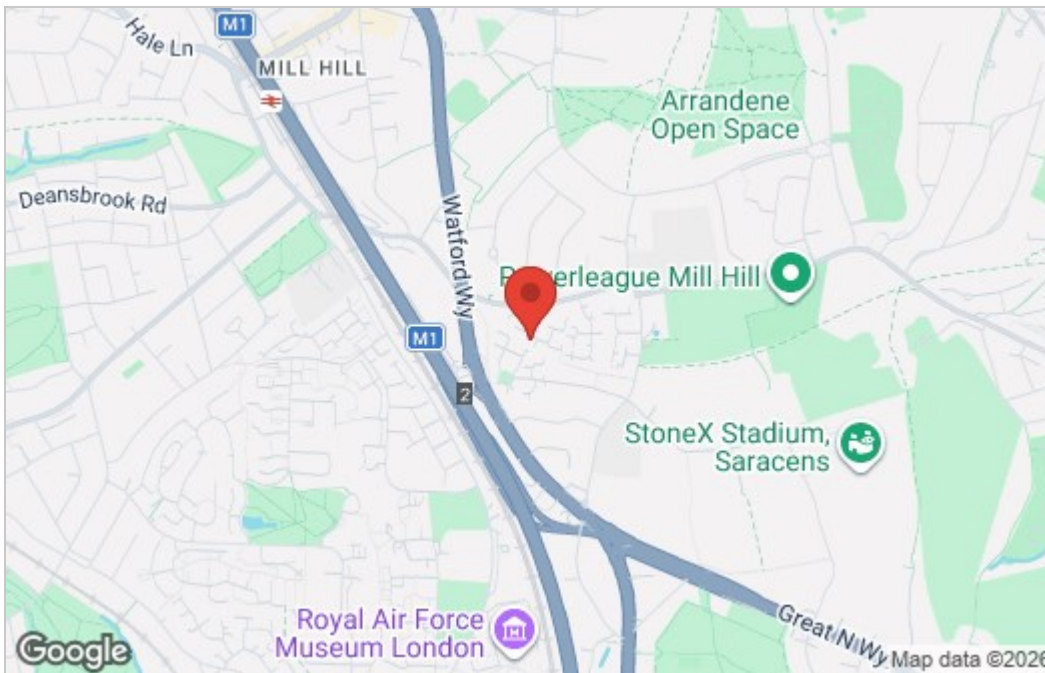

Energy Efficiency Graph

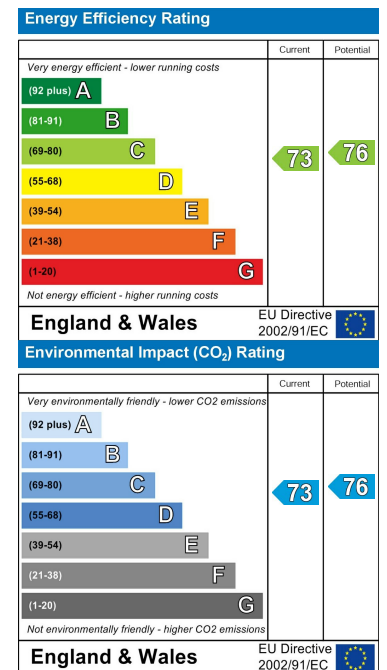

These particulars, whilst believed to be accurate are set out as a general outline only for guidance and do not constitute any part of an offer or contract. Intending purchasers should not rely on them as statements of representation of fact, but must satisfy themselves by inspection or otherwise as to their accuracy. No person in this firm's employment has the authority to make or give any representation or warranty in respect of the property.



Edgware Office- 194 Station Road, Edgware, HA8 7AT. Tel: 020 8958 1118
 Bushey Heath Office- 59 High Road, Bushey, WD23 1EE. Tel: 020 8950 7777
www.benjaminstevens.co.uk